

Alex Chernov
Stefan Polatschek
Martin Kummer
David Perzl

„Never delegate understanding.“ Charles Eames

Background
Contributing factors analyzed
Supplemental story: Martin's diary

Background

WA, 2013
Contemporary Austrian Kachelofen
air-gap system
Built mostly with EU materials

Austria, 2014
Comparative testing
Grundofen + Bell heater
Both built with EU materials

WA, 2019
Heater with air-gap system
Built using US materials only

Masons may often say „It won't work!“

It will work by sharing dreams, techniques and experiences through our comparative approach!



functional design: techn. dimensions, feeling comfy, views, distances etc.



Wildacres 2013 - Austrian hands-on result

1 Basic menu

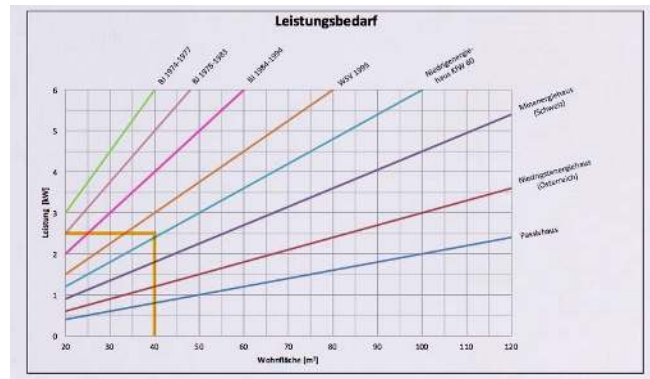

heat load and insulation quality, Ortnr Heizkultur 2014 brochure

Quality of insulation,
airtightness,
heat requirements

Dry firewood in stock!



somewhere in Europe

Human (f)actors
customer / inhabitant
planning teams
masons and construction teams



customer specs 2018

Architectural - structural
floor plan layout, positioning ...

Coordination, planning, calculation,
teamwork, documentation

Promotion, Social media ...
individual settings

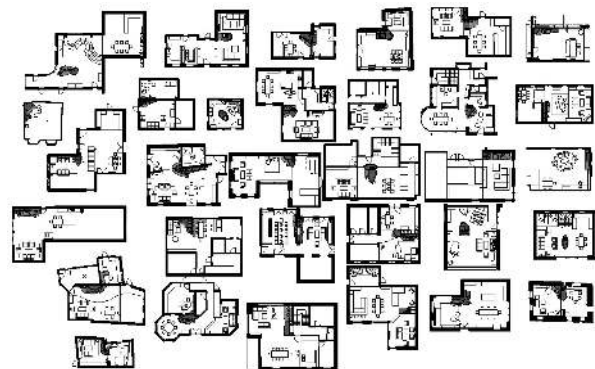

comparison of floorplan-layouts WA 2013

2 Heater menu

Firebox, fire door, combustion air

Heat storage device

Partial elements
acting as one functional unit



Jason Temple, 2018

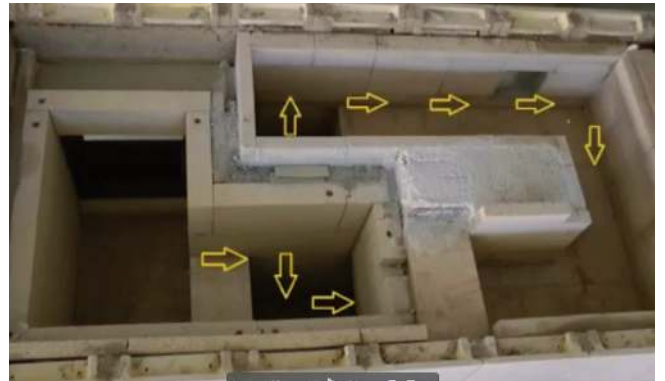

heat storage, channel system by Ratz, Austria 2012 (Y)



Martin Kummer, 2009 © loxpix

Heatkit with rear white oven and wraparound heated bench Upper Peninsula, Michigan



MHA website 2018

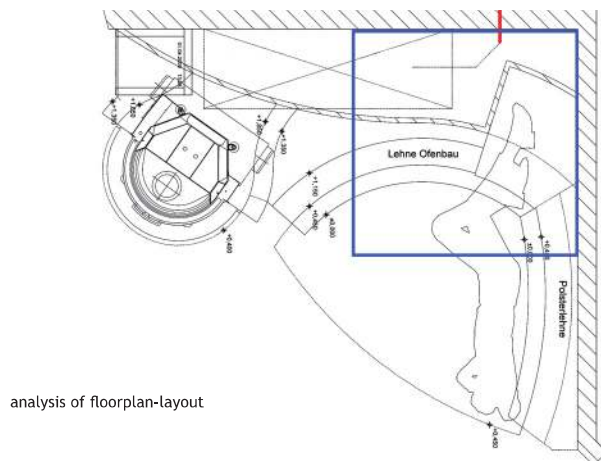

analysis of floorplan-layout

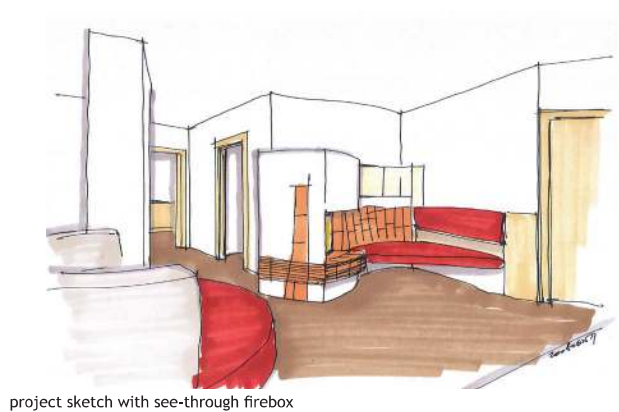

project sketch with see-through firebox

3 Functional menu

Dimensioning
(calculation, simulation, testing ...)

Type of construction
(custom built, air-gap system ...)

Gas physics (fast, slow ...)

Technology, size and proportion
(FI, SE, J // Bell, AT // and more)

(shapes more vertically, horizontally,
less / more flexible shapes and results)

Specifications of materials used
(spreadsheet €, \$...)

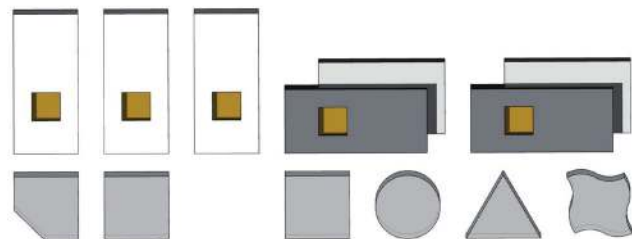
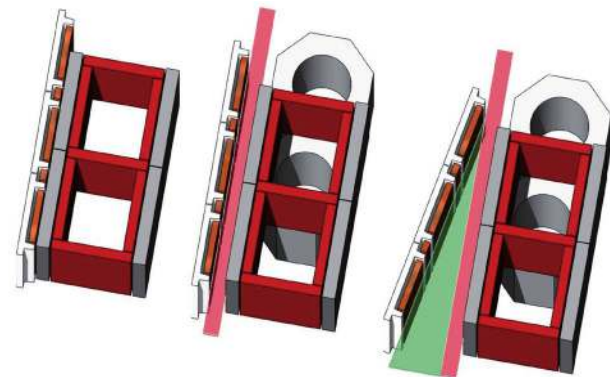
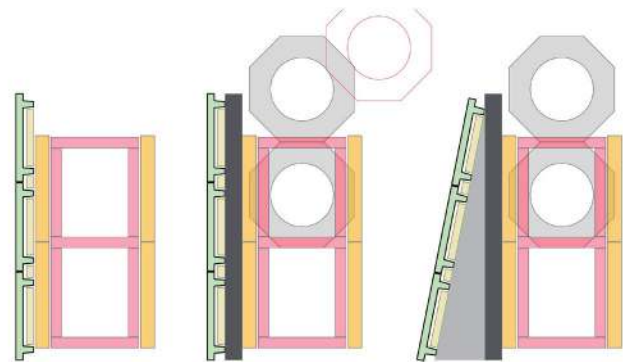

finetuning: KMS, T++, slow KBPl, longer storage (Die Hafnerei, 2014)



finetuning: refractory, ins.mass+, T-, takes longer until warm (Die Hafnerei, 2012)

4 Setting dial for our project

this choice will affect both artwork and technical design

local materials only

refractories
concrete
soap-stone
plaster
mortars

Alex' firebox, standard fire door

Hybrid Bell heater plus channel system
mixed, partly stainless flue liners

additional metal mesh,
plastered surface

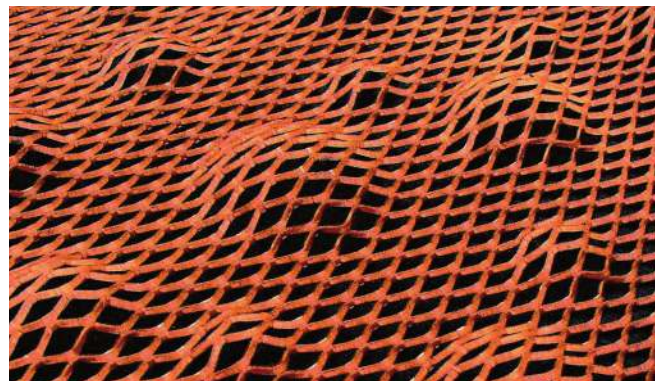
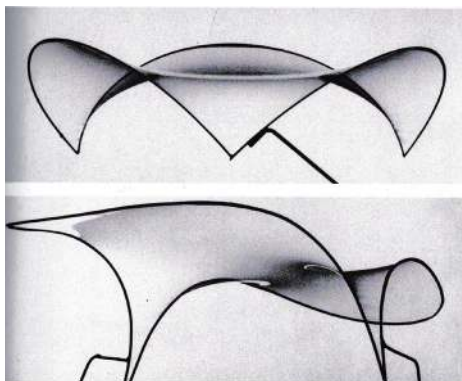

5 Shaping our project

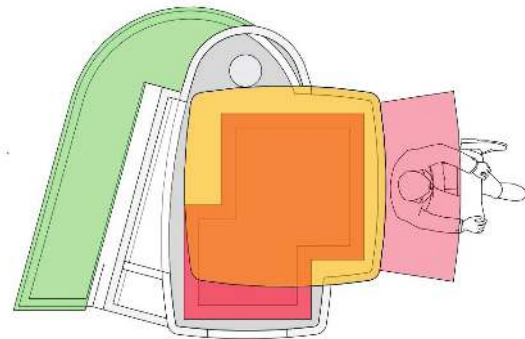

WA 2019 / hands-on / sketch 27.02.19, AC step

Dimensional requirements,
(warm) bench for pizza party
Inclined backrest for comfy seating,
varying surfaces

Design features customizable within limits.

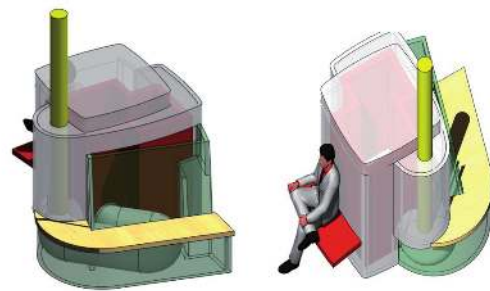

WA 2019 / hands-on / sketch 27.02.19, AC step

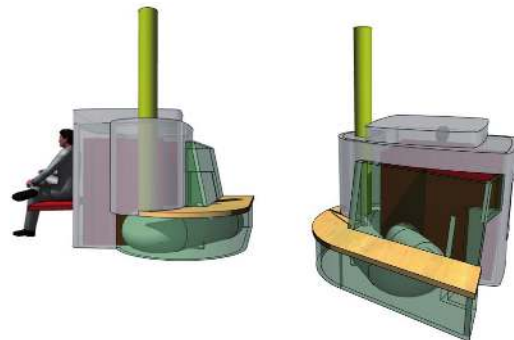

WA 2019 / hands-on / sketch 27.02.19, AC step

International teamwork,
intended delivery at pizza party:

It will work!

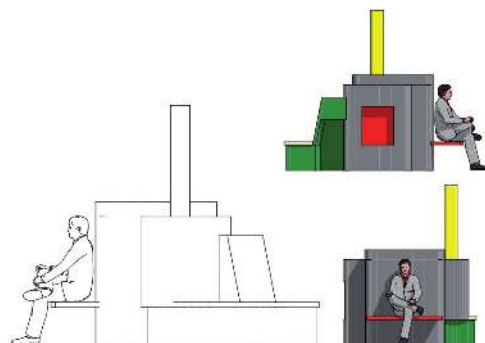

WA 2019 / hands-on / sketch 27.02.19, AC step

Additional considerations

Martin Kummer Feuerspuren (Fire Lanes)

A new book outlining 35 years of Martin's work as a stove builder.

We invite interested masons to review projects presented in the book, discuss details, implications and opportunities while going through the story of Martin's work journey.

His experience likewise allows anyone to discuss tasks and approaches when building our hands on project at WA:

Technical design and artwork, availability and choice of materials, teambuilding and many many more.



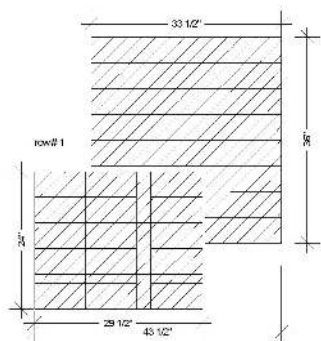

WA_2019_plan_row1

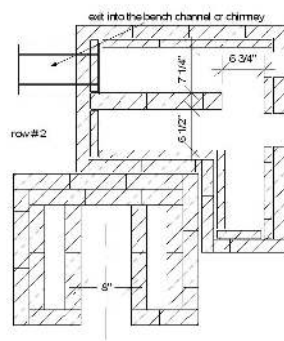

WA_2019_plan_row2

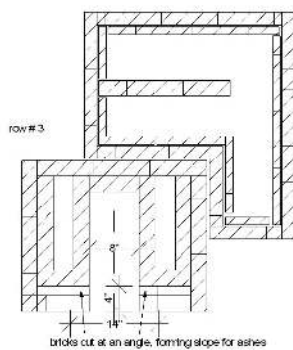

WA_2019_plan_row3

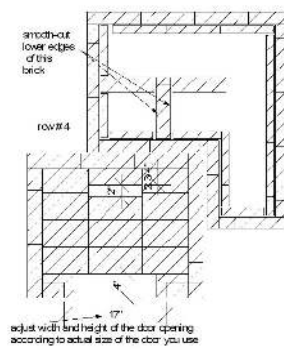

WA_2019_plan_row4

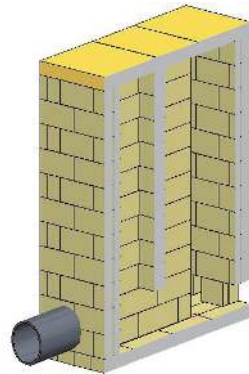

WA_2019_3D_cross_02

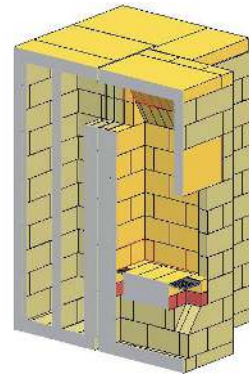

WA_2019_3D_cross_00

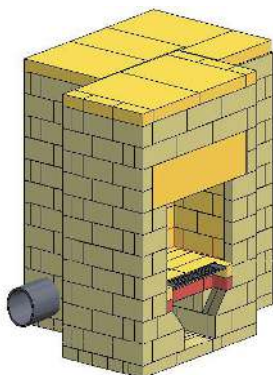

WA_2019_3D_views_00

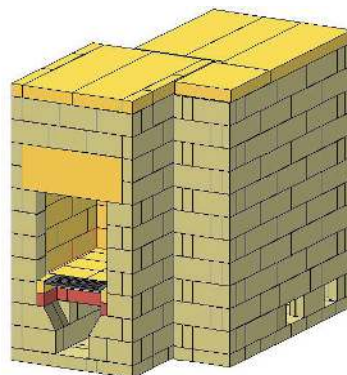

WA_2019_3D_views_01

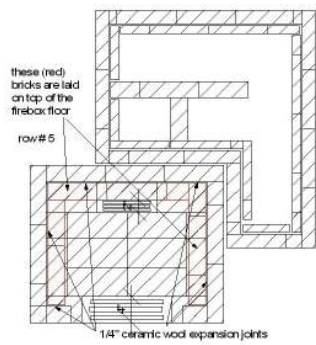

WA_2019_plan_row5

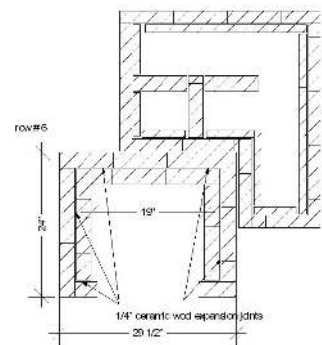

WA_2019_plan_row6

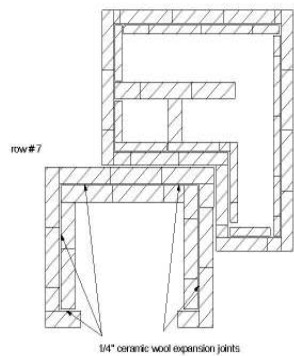

WA_2019_plan_row7

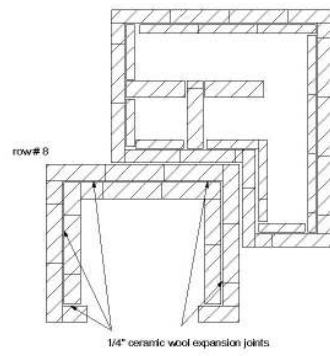

WA_2019_plan_row8

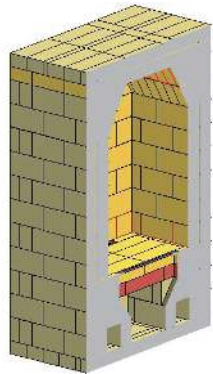

WA_2019_firebox_3D_cross_01

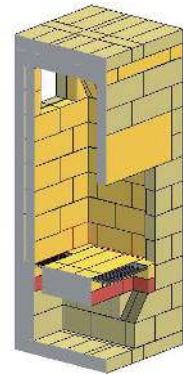

WA_2019_firebox_3D_cross_02

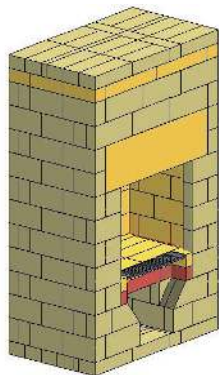

WA_2019_3D_views_02

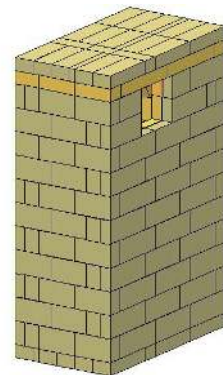

WA_2019_3D_views_03

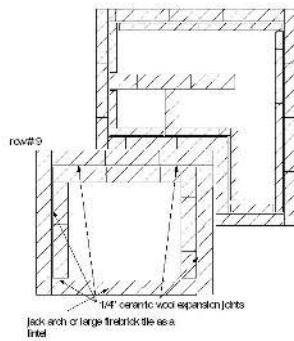

WA_2019_plan_row9

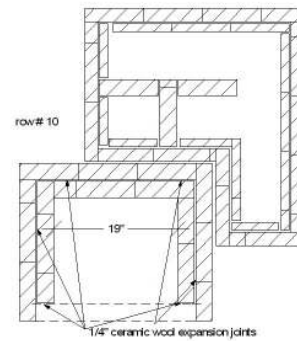

WA_2019_plan_row10

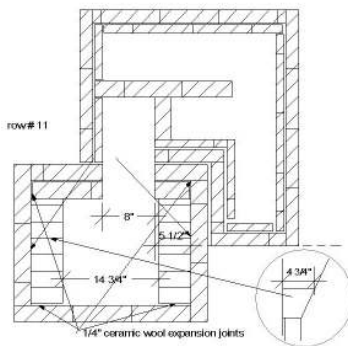

WA_2019_plan_row11

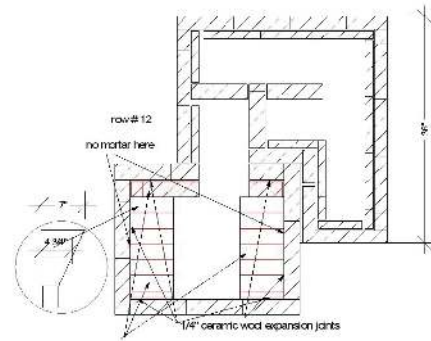

WA_2019_plan_row12

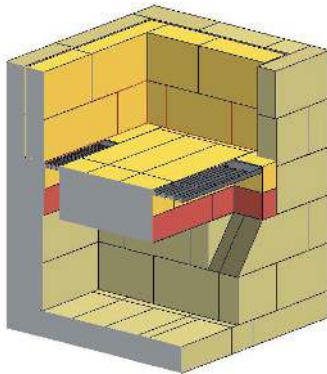

WA_2019_firebox_3D_cross_row1-6

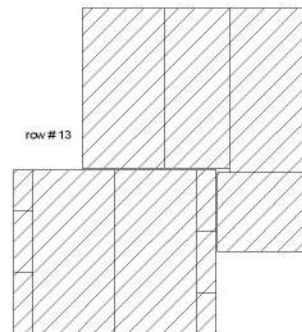

WA_2019_plan_row13

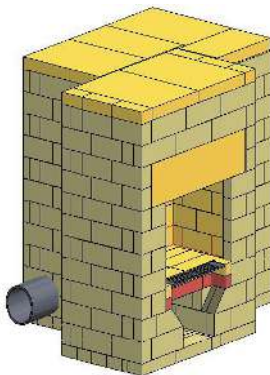

WA_2019_3D_views_00

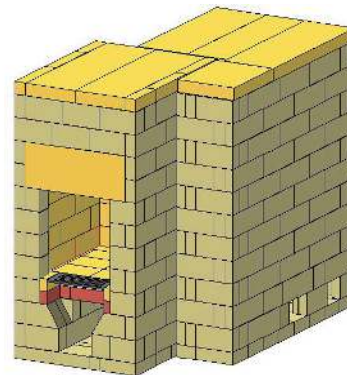

WA_2019_3D_views_01